

United States Department of the Interior  
National Park Service

# National Register of Historic Places Registration Form

This form is for use in nominating or requesting determinations for individual properties and districts. See instructions in National Register Bulletin, *How to Complete the National Register of Historic Places Registration Form*. If any item does not apply to the property being documented, enter "N/A" for "not applicable." For functions, architectural classification, materials, and areas of significance, enter only categories and subcategories from the instructions.

## 1. Name of Property

Historic name: Spence Confectionery and Dance Hall

Other names/site number: Idlewild Confectionery, Maughan Confectionery, Wellsville Confectionery

Name of related multiple property listing:

N/A

(Enter "N/A" if property is not part of a multiple property listing.)

## 2. Location

Street & number: 85 E. Main Street

City or town: Wellsville State: UT County: Cache

Not For Publication:  Vicinity:

## 3. State/Federal Agency Certification

As the designated authority under the National Historic Preservation Act, as amended,

I hereby certify that this X nomination \_\_\_ request for determination of eligibility meets the documentation standards for registering properties in the National Register of Historic Places and meets the procedural and professional requirements set forth in 36 CFR Part 60.

In my opinion, the property X meets \_\_\_ does not meet the National Register Criteria. I recommend that this property be considered significant at the following level(s) of significance:

\_\_\_ national \_\_\_ statewide X local

Applicable National Register Criteria:

X A \_\_\_ B \_\_\_ C \_\_\_ D

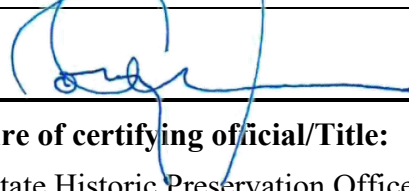
	/Deputy SHPO	2/5/2026
<b>Signature of certifying official/Title:</b>		<b>Date</b>
<u>Utah State Historic Preservation Office</u>		
<b>State or Federal agency/bureau or Tribal Government</b>		

Spence Confectionery and Dance Hall  
Name of Property

Cache County, Utah  
County and State

In my opinion, the property \_\_\_ meets \_\_\_ does not meet the National Register criteria.

---

<b>Signature of commenting official:</b>	<b>Date</b>
<b>Title :</b>	<b>State or Federal agency/bureau or Tribal Government</b>

#### 4. National Park Service Certification

I hereby certify that this property is:

- \_\_\_ entered in the National Register
- \_\_\_ determined eligible for the National Register
- \_\_\_ determined not eligible for the National Register
- \_\_\_ removed from the National Register
- \_\_\_ other (explain:) \_\_\_\_\_

\_\_\_\_\_  
Signature of the Keeper

\_\_\_\_\_  
Date of Action

#### 5. Classification

##### Ownership of Property

(Check as many boxes as apply.)

- Private:
- Public – Local
- Public – State
- Public – Federal

Spence Confectionery and Dance Hall  
Name of Property

Cache County, Utah  
County and State

**Category of Property**

(Check only **one** box.)

- Building(s)
- District
- Site
- Structure
- Object

**Number of Resources within Property**

(Do not include previously listed resources in the count)

Contributing	Noncontributing	
<u>1</u>	_____	buildings
_____	_____	sites
_____	_____	structures
_____	_____	objects
<u>1</u>	_____	Total

Number of contributing resources previously listed in the National Register N/A

**6. Function or Use**

**Historic Functions**

(Enter categories from instructions.)

COMMERCE/TRADE: Specialty Store  
RECREATION AND CULTURE: Dance Hall

**Current Functions**

(Enter categories from instructions.)

COMMERCE/TRADE: Restaurant

Spence Confectionery and Dance Hall  
Name of Property

Cache County, Utah  
County and State

---

## 7. Description

### Architectural Classification

(Enter categories from instructions.)

LATE 19<sup>TH</sup> AND EARLY 20<sup>TH</sup> CENTURY AMERICAN MOVEMENTS:

Commercial Style

OTHER: One-part block

**Materials:** (Enter categories from instructions.)

Principal exterior materials of the property: BRICK

### Narrative Description

(Describe the historic and current physical appearance and condition of the property. Describe contributing and noncontributing resources if applicable. Begin with a **summary paragraph** that briefly describes the general characteristics of the property, such as its location, type, style, method of construction, setting, size, and significant features. Indicate whether the property has historic integrity.)

---

#### Summary Paragraph

The Spence Confectionery and Dance Hall, built in 1917, is a one-part block located at 85 E. Main Street in Wellsville, Cache County, Utah. The one-story brick building features the tall windows of a Victorian commercial storefront but is devoid of any ornamentation beyond some modest corbelled brick, and is an example of the Commercial style. The building faces south on Wellsville's Main Street and is flanked by a one-story store (circa 1925) to the east and a one-story pool hall to the west (circa 1929). In 1982, the confectionery and the pool hall buildings were combined and converted to a reception center with a Western-themed plank false front. The building and a circa 2005 metal shed addition at the rear filled nearly all of the 0.05 acre rectangular parcel. The false front and the non-historic shed were removed by the current owner in 2023, creating a small patio space. The building was recently rehabilitated as a federal historic preservation tax credit project, restoring much of the historic integrity in the qualities of location, setting, design, materials, workmanship, feeling, and association. The property contributes to the history of Wellsville's one-block wide commercial district.

---

#### Narrative Description

##### Exterior

The 1917 confectionery building was constructed on a concrete foundation. The façade brick is a pink and yellow face brick [Photographs 1-4, Map #3]. The façade was painted white and later yellow before the false front was installed in 1982 [Figures 3-4]. During the façade rehabilitation, the brick was repainted white. The brick masonry is laid in a running bond with flush mortar joints. The projecting pilasters flanking the façade have an unusual detail: they are corbeled inward

Spence Confectionery and Dance Hall  
Name of Property

Cache County, Utah  
County and State

at the base where it meets the sidewalk. The pilasters feature a concrete coping covered in metal. Originally, the pilasters extended above the parapet. However, the caps were removed and these were made flush with the parapet possibly when the two storefronts were combined behind a false front. Thinner flush pilasters divide the façade into three bays, with a central entrance flanked by storefront windows [Photograph 4].

After a vacancy of over a decade, the confectionery and the building next door to the east (81 E. Main) were combined into a single property and a western-themed false front installed on both facades in 1982 [Figure 4].<sup>1</sup> The false front was removed in 2023. Above the store front windows is a painted concrete beam. In the parapet above the beam, there is a sign panel surrounded by projecting header and rowlock bricks. The parapet has a single course of corbeled brick at the top. Sometime before 1940, a large crack appeared in the center of the façade parapet. The brick along the crack has been repointed several times, including the current rehabilitation [Photograph Figures 1 & 5].

The original door was offset in the central bay with a sidelight. The flanking display windows rested on a plain wood bulkhead. The transom windows above the entrance and display area were divided into two lights. In another unusual feature, a second, taller pair of clerestory windows was built above each transom [Photograph 4]. In the early 1960s, these windows were removed and the space covered with clapboard siding. At the same time, the front door was moved to the center of the central bay and surrounded by clapboard siding. Similar siding was used to cover the bulkheads. The current project included the rehabilitation of the display windows, compatible wood replacement transom windows and a 15-light door similar to the one installed in the 1960s.

The east and west elevations are barely visible above the adjoining buildings. There appear to have been no openings on either elevation before the buildings to the east (circa 1925) and the west (circa 1929) were built. The original configuration of the north (rear) elevation is unknown, but there were horizontal windows and an off-center rear entrance. The interior of the rear wall has been partially built with hollow core tile (date unknown). The rear (north) elevation is mostly covered in gray stucco, which has partially sloughed off revealing the original brick walls [Photograph 5, Figure 5]]. The rear window openings were blocked with plywood prior to the rehabilitation. The rear door was replaced when the seamed metal shed addition was built circa 2005. The light-gray-colored shed had a shed roof attached to the building to the west. There were two windows facing east and a garage door facing north. The shed addition was removed as part of the rehabilitation. The stucco and brick were gently cleaned and retained as is. The missing transom windows on the rear elevation were replaced with compatible wood windows [Photograph 6]. A new half-glass security door was installed.

## Interior

The confectionery building has 1,600 square feet of space in the interior. There have been at least three remodels since the original construction date with the interior kept fairly open in each iteration. Remnants of two layers of wallpaper over the original plaster are visible [Figure 2]. The

<sup>1</sup> The Baugh Billiards and Pool Hall at 81 E. Main Street is also part of the current rehabilitation tax credit project. A separate National Register of Historic Places nomination has been prepared for this building.

Spence Confectionery and Dance Hall  
Name of Property

Cache County, Utah  
County and State

ceiling was dropped and finished by the 1940s, but not originally since the older plaster reaches the trusses. The most significant alteration occurred in 1982 when a door was cut between the confectionery and its neighbor to the west [Photograph 6]. Around that time, framing was placed around the industrial kitchen fan as well as the restrooms. These partitions were removed prior to the current rehabilitation. The original maple floor was damaged by later floor coverings and was removed. The current flooring is a layer of concrete (date unknown).

During the rehabilitation, the ceiling was replaced at its historic level and the walls in the public spaces were plastered and painted keeping the public space partially finished as it was in the 1940s [Figure 2]. The concrete floor was polished. The interior was braced with slender steel posts that have a minimal impact on the interior [Photographs 7-8]. The door to the west building was retained but is not in use. The new tenant finishes include a counter, drink station, and small kitchen [Photograph 9]. In the rear one-third of the interior, some walls were left unfinished with the brick and hollow core tile on view [Photograph 10]. These spaces include the dishwashing room, two restrooms, and a small breakroom.

### Site

The Spence Confectionery is a one-part-block-type building measuring approximately 23 by 73 feet. The building takes up most of its 0.05-acre parcel. The façade (south elevation) abuts the public sidewalk along Main Street. There is a lamppost in front of the building but no landscaping [Photograph 1, Figures 1 & 3]. The confectionery is one of four historic commercial buildings that contribute to the streetscape of the commercial district [Maps 1-2]. Only a few feet of the west and east elevations are visible above the adjoining buildings. The remaining parcel has equipment and a single parking space. There is additional gravel parking for the four buildings accessible from a driveway off 100 East.

### Historic Integrity

The Spence Confectionery and Dance Hall has good integrity for the period of significance between 1917 and 1970. The location of the building is particularly important since the building contributes to the historic commercial district, which, in the small town of Wellsville, is confined to the north side of a single block of Main Street. The removal of the Western-themed false front from the Spence Confectionery and its neighbor has restored an important section of historic Main Street, boosting the qualities of setting, feeling, and the association of a storefront. The qualities of design, materials, and workmanship have been minimally impacted by a few window and door replacements, but the elements are compatible and similar in materials and design to those seen in historic photographs. The Spence Confectionery and Dance Hall contributes to the historic integrity of Wellsville.

Spence Confectionery and Dance Hall  
Name of Property

Cache County, Utah  
County and State

## 8. Statement of Significance

### Applicable National Register Criteria

(Mark "x" in one or more boxes for the criteria qualifying the property for National Register listing.)

- A. Property is associated with events that have made a significant contribution to the broad patterns of our history.
- B. Property is associated with the lives of persons significant in our past.
- C. Property embodies the distinctive characteristics of a type, period, or method of construction or represents the work of a master, or possesses high artistic values, or represents a significant and distinguishable entity whose components lack individual distinction.
- D. Property has yielded, or is likely to yield, information important in prehistory or history.

### Criteria Considerations

(Mark "x" in all the boxes that apply.)

- A. Owned by a religious institution or used for religious purposes
- B. Removed from its original location
- C. A birthplace or grave
- D. A cemetery
- E. A reconstructed building, object, or structure
- F. A commemorative property
- G. Less than 50 years old or achieving significance within the past 50 years

Spence Confectionery and Dance Hall  
Name of Property

Cache County, Utah  
County and State

**Areas of Significance**

(Enter categories from instructions.)

COMMERCE  
ENTERTAINMENT/RECREATION  
\_\_\_\_\_

**Period of Significance**

1917-1970  
\_\_\_\_\_

**Significant Dates**

1917  
1924  
1950  
\_\_\_\_\_

**Significant Person**

(Complete only if Criterion B is marked above.)

N/A  
\_\_\_\_\_

**Cultural Affiliation**

N/A  
\_\_\_\_\_

**Architect/Builder**

Fred E. Douglas: builder  
\_\_\_\_\_  
\_\_\_\_\_

Spence Confectionery and Dance Hall  
Name of Property

Cache County, Utah  
County and State

**Statement of Significance Summary Paragraph** (Provide a summary paragraph that includes level of significance, applicable criteria, justification for the period of significance, and any applicable criteria considerations.)

The Spence Confectionery and Dance Hall, built in 1917, in Wellsville, Cache County, is locally significant under Criterion A in the area of Commerce as an example of a small town confectionery that thrived for over fifty years despite competition from large-scale candy producers located in the county seat of Logan only nine miles away. Cache Valley was Utah's highest dairy producing region through most of the twentieth century and the candy industry thrived in the valley. In 1917, Spence Confectionery was one of half a dozen small town confectioneries outside of Logan. The property is significant as the only example that did not change usage throughout most of the twentieth century, despite several transfers of ownership. The period of significance spans the original construction in 1917 to the closing of the confectionery business in 1970. The use of the building as a dance hall only lasted five years, between 1917 and 1922. However, the building is also significant in the area of Entertainment/Recreation as the only extant example of an early twentieth-century dance hall, an important venue for events for small towns in Utah, where religious recreation halls were traditionally more acceptable for social events than commercial buildings due to the influence of the Church of Jesus Christ of Latter-day Saints (LDS or Mormon Church) in most aspects of community life.

**Narrative Statement of Significance** (Provide at least **one** paragraph for each area of significance.)

### **Significance in the Area of Commerce**

The Spence Confectionery and Dance Hall in Wellsville is locally significant in the area of Commerce for two reasons. First, for its remarkable longevity as a confectionery lasting for fifty-three years between 1917 and 1970 despite competition from nearby large-scale wholesale and retail candy companies. And second, as one of the four adjoining extant commercial buildings from the early twentieth century on Wellsville's Main Street. The Spence Confectionery represents a period of commercial growth for the town during which the original small frame buildings were replaced by more substantial brick commercial blocks.

Within a few years of the first settlements in Cache County in the 1860s, it became clear that the isolated valley possessed an ideal climate for dairy cows. By the end of the nineteenth century, Cache County took the lead in producing milk, cheese, and butter in the state of Utah. In the first quarter of the twentieth century, the valley's dairy industry began producing a number of specialty products, such as canned milk, cheese, yogurt, and ice cream. Naturally, the candy-making industry also thrived during this period. In Logan, the county seat, there were between four and six wholesale candy-makers during the first half of the century. The largest candy-maker, the Bluebird Candy Company, was founded in 1914, and is still in business today. Between the 1930s and the 1960s, the Bluebird Candy Company filled a three-story, 330,000 square-foot factory in the alley behind its iconic restaurant/confectionery Logan's Main Street. The Bluebird Café is a contributing building in the *Logan Center Street Historic District* (NRIS #79002488). The factory

Spence Confectionery and Dance Hall  
Name of Property

Cache County, Utah  
County and State

was demolished in 1969. During the period of significance between 1917-1970, Logan City had numerous retail confectioneries according to the city directories, peaking at ten listings in 1940.

Outside of Logan, nine of Cache County's twenty-one smaller towns were listed in the city directories with a dedicated confectionery for at least one year between 1917 and 1940: Benson, Hyrum, Lewiston, Newton, Mendon, Paradise, Richmond, Smithfield, and Wellsville. By the 1940s, only four remained, including the Spence Confectionery in Wellsville. Since no addresses were provided for rural Cache County, the number of extant commercial buildings associated with these businesses is difficult to quantify. A few may have been in private residences, a few have probably been demolished, but most appear to have been converted to other uses. A good example is the NRHP-listed *Hendricks Confectionery Building* in Richmond (NRIS #04001122). The Hendricks Confectionery, built in 1911, was converted into a drugstore in the late 1930s, at a time when drugstores with soda fountains had cornered the market on the selling of candy and ice cream.

In this historic context, the Spence Confectionery in Wellsville is an exceptional long term representative of the confectionery business model. The confectionery sold candy and other sweets under various names within the period of significance: Spence Confectionery (1917-1921), Wellsville Confectionery (1922), Idlewild Confectionery (1923-1934), Wellsville Confectionery (1935-1936), Maughan's Confectionery (1937-1944, 1947-1949), Ken's Confectionery (1945-1946). Under the Olsen family ownership between 1950 and 1970, the business was known as an ice cream parlor and the confectionery sign was painted over; however, it continued to be referred to as a confectionery in the local newspapers. By the late 1960s, only one other Cache County business (located in Logan) was referred to by the old-fashioned name for a candy store.

The longevity of Wellsville's only confectionery may be due to the size and stability of the population during most of the twentieth century. In 1910, the population of Wellsville reached 1,195. After a peak of 1,402 in 1940, the population had decreased to 1,267 people in 1970. The Main Street commercial district reflects this building inertia. The four brick buildings extending west from the corner of Main Street and 100 East represent the core of the commercial business district within the period of significance. The bank building (including drugstore and clothing store) at the corner was built in 1911. The brick Spence Confectionery and Dance Hall, built in 1917, replaced an older frame confectionery. A brick grocery store and barbershop was added (circa 1925) between the bank and the confectionery building. Finally, a brick billiards and pool hall was built along the west wall of the confectionery around 1929, replacing a frame pool hall. These four buildings remain the core of the commercial district and replaced a handful of small frame buildings. Further west on Main Street are a train depot (remodeled), Wellsville's only historic two-part block, and a large garage structure. A few other commercial buildings are scattered around town, mostly service stations (circa 1920s-1950s) and the Morning Milk Plant (built in 1928).

### **Significance in the Area of Entertainment/Recreation**

The Spence Confectionery and Dance Hall is also significant under Criterion A in the area of Entertainment/Recreation because it is the only historic dance hall left in Wellsville representing

Spence Confectionery and Dance Hall  
Name of Property

Cache County, Utah  
County and State

an important building type used for social and recreational events. The building is particularly significant as a dance hall on Wellsville's small commercial district. It is the only extant example of an early twentieth-century dance hall, in the small town of Wellsville where church amusement halls were traditionally more acceptable for social events, especially for young people, than commercial buildings due to the influence of the LDS Church over venues built for entertainment or recreation.

When the Spence Confectionery and Dance Hall was built in 1917, it was intended for two purposes: candy sales and dancing. An article in the *Logan Journal* described the building as one of the "new and up-to-date business blocks, being erected by some of our enterprising merchants" and George Spence, the proprietor, "extends an invitation to everyone to come and enjoy a quiet dance on his smooth maple floor."<sup>2</sup> The confectionery opened for business on Thanksgiving Day 1917.

The building was constructed by Fred E. Douglas, Wellsville's most prolific builder of the early twentieth century. The *Journal* in Logan reported that "Mr. Spence has installed a modern heating plant, a \$1200 fountain, and a \$1600 piano for his new dance hall connected with the confectionery."<sup>3</sup> Although only used as a dance hall for approximately five years, the Spence building is the only extant example of an early twentieth-century commercial dance hall left in Wellsville. Two church buildings associated with the Church of Jesus Christ of Latter-day Saints (LDS or Mormon Church) had amusement halls. The church sponsored dances where young people could mingle and socialize under proper supervision. Both buildings were demolished by 1980. The town's secular dance hall, known as the Pavilion, was built in 1905 just around the corner from the Main Street commercial district. The large frame building could accommodate up to 400 persons. The Pavilion burned to the ground in the 1930s.<sup>4</sup> It was likely George Spence thought the community could use a venue for more intimate events. One of the first events held at the Spence Confectionery and Dance Hall was a "dancing party" attended by eleven young couples.<sup>5</sup>

### Additional Historical Information

The earliest confectionery stores in Wellsville included home kitchens, a moveable wagon, and small frame buildings. In 1911, John A. Brown operated a confectionery and tobacco shop just west of the drugstore and bank. The Wellsville history book, *Windows of Wellsville* notes that John Brown sold his confectionery to George Spence on February 3, 1917.<sup>6</sup> County records indicate the land was owned by Lorin M. and Maggie G. Haslam, who sold it to George Spence in September of 1917. Construction of the brick building was completed in November 1917 by Frederick "Fred" Edward Douglas (1865-1946). Fred E. Douglas and his partner, Job Hill Miller (1853-1913), operated a brick yard, and built numerous homes, businesses, and churches throughout Cache County.

<sup>2</sup> *The Journal (Logan)*, November 22, 1917.

<sup>3</sup> *The Journal (Logan)*, December 5, 1917.

<sup>4</sup> Wellsville History Committee, *Windows of Wellsville, 1856-1984: A one hundred and twenty-eight year written and pictorial history of Wellsville, Utah*, (Providence, Utah: Keith W. Watkins and Sons, Inc., 1985): p. 306-307.

<sup>5</sup> *The Journal (Logan)*, December 5, 1917.

<sup>6</sup> *Windows of Wellsville, 1856-1984*: p. 148.

Spence Confectionery and Dance Hall  
Name of Property

Cache County, Utah  
County and State

George Morrison Spence (1858-1943) was a Scottish immigrant who settled in Wellsville with his wife, Harriet Lydia Brenchley Whiton Spence (1862-1943) in 1873. He worked at the Hansen Creamery in Logan for twenty years before opening the confectionery in 1917. George and Harriet's adopted daughter, Annabel McMahon Spence Taylor (1890-1978), was a clerk at the Spence Confectionery, later known as the Wellsville Confectionery in 1922 and the Idlewild Confectionery in 1923. In April 1924, George and Harriet Spence sold the property to Archibald H. Maughan. Archibald Hill Maughan (1873-1942) and his wife, Mary Poppleton Walters Maughan (1875-1958), owned the property until 1937. During this time, their oldest son, Vernon Walter Maughan (1899-1974) operated the confectionery under the names Idlewild and Wellsville Confectionery.

Vern Maughan, and his wife, Anona Thompson Maughan (1904-1993), purchased the confectionery property in September 1937 from his parents. From that time forward, the business was known as Maughan's Confectionery. The property passed to Wilford Ferguson Baugh (1893-1947) and his wife, Isabell Henry Parker Baugh (1897-1975). Wilford Baugh was a real estate investor and did not participate in running the confectionery, which continued for a short time under Vern Maughan's management until 1944.

In 1944, the Baugh family sold the property to Nephi Lauritz Larsen (1888-1980) and Martha Mae Taylor Larsen (1888-1957) who also did not manage the store. Later that year, the Larsens sold the property to Kenneth Bailey Murray (1902-1996) and his wife, Cecila Poppleton Maughan Murray (1904-2005), and the business was known briefly as Ken's Confectionery. After two years, in 1946, the Murrays sold the property to Alan Dale Bradshaw Maughan (1921-2015) and June Godderidge Maughan (1924-1982). Dale Maughan made his own ice cream for the store. He was distantly related to Vernon Maughan.

In August 1950, the Maughans sold the property to Cliff Andrew Olsen (1903-1977) and Mabel B. Green Olsen (1908-2000). Cliff and Mabel turned the management of the store to their newly married daughter, Carma Olsen Maughan. The 1950 census lists Carma Maughan as a saleslady for a retail candy store and café. Later, Stennett "Gib" Poppleton managed the store until it closed around 1970.

The Olsens sold the property to Frank Pete and Katherine Miller. The building was vacant for twelve years, during which time the property changed hands four times. In 1982, the building was consolidated with the adjoining former pool hall to the west behind a single new façade. The two buildings served as a reception center, supper club, an antique store, and an artist studio before being acquired by the current owner in 2022. The rehabilitated building is currently occupied by Chef D's, a sandwich shop.

Spence Confectionery and Dance Hall  
Name of Property

Cache County, Utah  
County and State

---

## 9. Major Bibliographical References

**Bibliography** (Cite the books, articles, and other sources used in preparing this form.)

Cache County. Recorder's Office and Assessor's Office.

Carter, Thomas and Peter Goss. *Utah Historic Architecture: A Guide, 1847-1940*. Salt Lake City, Utah: University of Utah Press, 1988.

*Logan Herald Journal*, various issues.

Peterson, F. Ross. *A History of Cache County*. Utah Centennial County History Series, Salt Lake City, Utah: Utah State Historical Society, 1996.

R. L. Polk Directories. *Logan and Cache County*, 1910-1988.

*Salt Lake Telegram* and *Salt Lake Tribune*, various issues.

United States Census Enumerations, *Richmond, Utah, 1910 -1950*.

Wellsville History Committee. *Windows of Wellsville, 1856-1984: A one hundred and twenty-eight year written and pictorial history of Wellsville, Utah located at the base of the majestic Wellsville Mountains*. Providence, Utah: Keith W. Watkins and Sons, Inc., 1985.

---

### Previous documentation on file (NPS):

- preliminary determination of individual listing (36 CFR 67) has been requested  
 previously listed in the National Register  
 previously determined eligible by the National Register  
 designated a National Historic Landmark  
 recorded by Historic American Buildings Survey # \_\_\_\_\_  
 recorded by Historic American Engineering Record # \_\_\_\_\_  
 recorded by Historic American Landscape Survey # \_\_\_\_\_

### Primary location of additional data:

- State Historic Preservation Office  
 Other State agency  
 Federal agency  
 Local government  
 University  
 Other  
Name of repository: \_\_\_\_\_

Spence Confectionery and Dance Hall  
Name of Property

Cache County, Utah  
County and State

**Historic Resources Survey Number** (if assigned): \_\_\_\_\_

---

## 10. Geographical Data

**Acreeage of Property** Less than one acre

Use either the UTM system or latitude/longitude coordinates

### Latitude/Longitude Coordinates

Datum if other than WGS84: \_\_\_\_\_  
(Enter coordinates to 6 decimal places.)

- |                         |                         |
|-------------------------|-------------------------|
| 1. Latitude: 41.638868° | Longitude: -111.932022° |
| 2. Latitude:            | Longitude:              |
| 3. Latitude:            | Longitude:              |
| 4. Latitude:            | Longitude:              |

### Verbal Boundary Description (Describe the boundaries of the property.)

BEG 67 FT W OF SE COR LOT 1 BLK 20 WELLSVILLE CITY N 100 FT W 23 FT S 100 FT E 23 FT TO BEG. SEC 3 T 10N R 1 W. (Current parcel number: 10-0222-006 Old: E162)

### Boundary Justification (Explain why the boundaries were selected.)

The boundaries are those associated with the property currently and historically.

---

## 11. Form Prepared By

name/title: Korral Broschinsky  
organization: Preservation Documentation Resource  
e-mail: kbros@kbropreservation.com  
telephone: 801-913-5645  
date: January 15, 2026

Spence Confectionery and Dance Hall  
Name of Property

Cache County, Utah  
County and State

---

### Additional Documentation

Submit the following items with the completed form:

- **Maps:** A **USGS map** or equivalent (7.5 or 15 minute series) indicating the property's location.
- **Sketch map** for historic districts and properties having large acreage or numerous resources. Key all photographs to this map.
- **Additional items:** (Check with the SHPO, TPO, or FPO for any additional items.)

### Photographs

Submit clear and descriptive photographs. The size of each image must be 1600x1200 pixels (minimum), 3000x2000 preferred, at 300 ppi (pixels per inch) or larger. Key all photographs to the sketch map. Each photograph must be numbered and that number must correspond to the photograph number on the photo log. For simplicity, the name of the photographer, photo date, etc. may be listed once on the photograph log and doesn't need to be labeled on every photograph.

### Photo Log

Name of Property: Spence Confectionery and Dance Hall

City or Vicinity: Wellsville

County: Cache State: Utah

Photographer: Korral Broschinsky

Date Photographed: December 17, 2024

Description of Photograph(s) and number, include description of view indicating direction of camera: 1 of 10. (See continuation sheets.)

Spence Confectionery and Dance Hall  
Name of Property

Cache County, Utah  
County and State

**Property Owner information:**

(Complete this item at the request of the SHPO or FPO.)

name: Heritage Preservation Inc. (contact: Tony Johnson or Lexi Johnson)

address: 594 S. 400 East

city or town: River Heights state: Utah zip code: 84321

telephone/email: (435) 764-5486

tony.johnson@amlutah.com, lexi.johnson@amlutah.com

**Paperwork Reduction Act Statement:** This information is being collected for nominations to the National Register of Historic Places to nominate properties for listing or determine eligibility for listing, to list properties, and to amend existing listings. Response to this request is required to obtain a benefit in accordance with the National Historic Preservation Act, as amended (16 U.S.C.460 et seq.). We may not conduct or sponsor and you are not required to respond to a collection of information unless it displays a currently valid OMB control number.

**Estimated Burden Statement:** Public reporting burden for each response using this form is estimated to be between the Tier 1 and Tier 4 levels with the estimate of the time for each tier as follows:

- Tier 1 – 60-100 hours
- Tier 2 – 120 hours
- Tier 3 – 230 hours
- Tier 4 – 280 hours

The above estimates include time for reviewing instructions, gathering and maintaining data, and preparing and transmitting nominations. Send comments regarding these estimates or any other aspect of the requirement(s) to the Service Information Collection Clearance Officer, National Park Service, 1201 Oakridge Drive Fort Collins, CO 80525.

United States Department of the Interior  
National Park Service

National Register of Historic Places  
Continuation Sheet

Section number MAPS Page 1

Spence Confectionery and Dance Hall
Name of Property
Cache County, Utah
County and State
N/A
Name of multiple listing (if applicable)

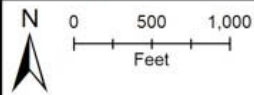
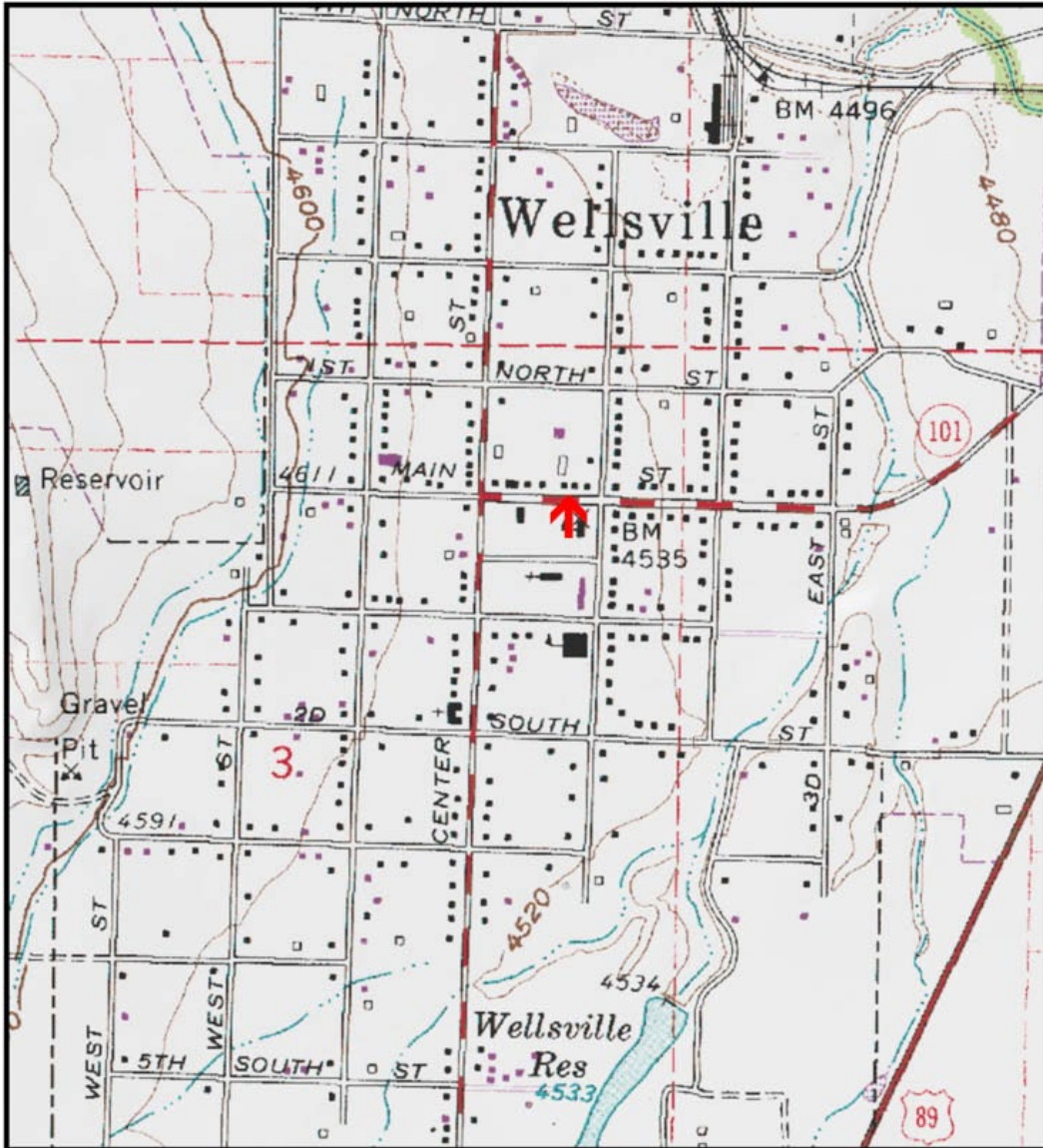

MAP #1

**Spence Confectionery and Dance Hall**  
85 E. Main Street, Wellsville, Cache Co., Utah

 Wellsville Commercial District on Main Street

GIS Data Courtesy Utah AGRC

**United States Department of the Interior**  
National Park Service

**National Register of Historic Places**  
**Continuation Sheet**

Section number MAPS Page 2

Spence Confectionery and Dance Hall
----- Name of Property
Cache County, Utah
----- County and State
N/A
----- Name of multiple listing (if applicable)

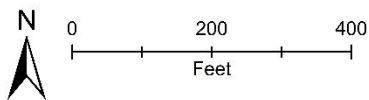

**Spence Confectionery and Dance Hall**  
85 E. Main Street, Wellsville, Cache Co., Utah

**MAP #2**

 Latitude: 41.638868° Longitude: -111.932022°

GIS Data Courtesy Utah AGRC

United States Department of the Interior  
National Park Service

National Register of Historic Places  
Continuation Sheet

Section number MAPS Page 3

Spence Confectionery and Dance Hall
Name of Property
Cache County, Utah
County and State
N/A
Name of multiple listing (if applicable)

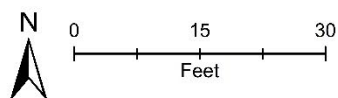
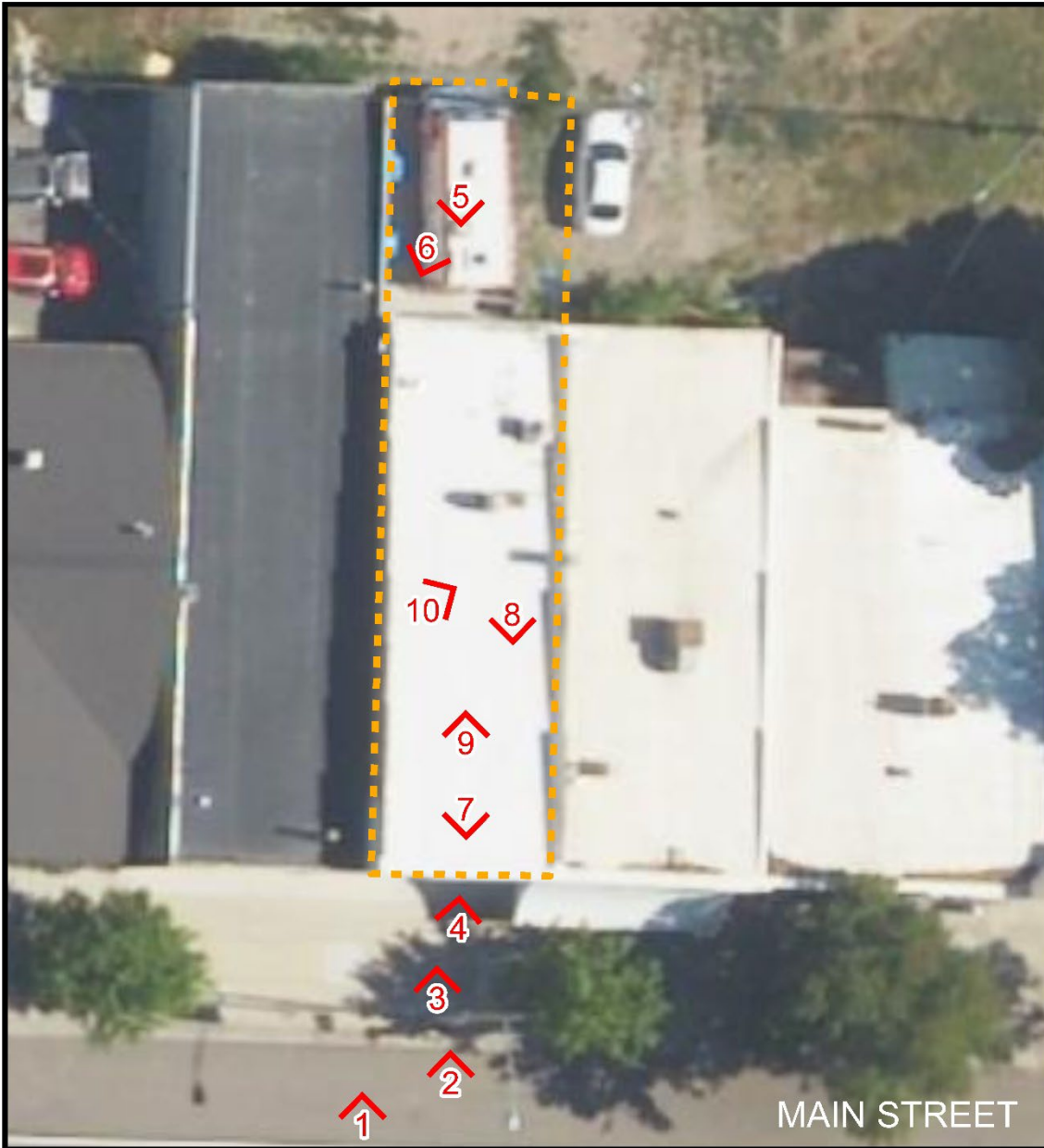

**Spence Confectionery and Dance Hall**  
85 E. Main Street, Wellsville, Cache Co., Utah

**MAP #3**

NRHP PHOTO KEY

Historic and Current Parcel

GIS Data Courtesy Utah AGRC

United States Department of the Interior  
National Park Service

# National Register of Historic Places Continuation Sheet

Section number PHOTOGRAPHS Page 1

Spence Confectionery and Dance Hall  
Name of Property

Cache County, Utah  
County and State

N/A  
Name of multiple listing (if applicable)



**Photograph 1:** South elevation of 85 E. Main on right (81 E. on left). Camera facing north.



**Photograph 2:** South elevation of building. Camera facing north.

United States Department of the Interior  
National Park Service

# National Register of Historic Places Continuation Sheet

Section number PHOTOGRAPHS Page 2

Spence Confectionery and Dance Hall

Name of Property

Cache County, Utah

County and State

N/A

Name of multiple listing (if applicable)



Photograph 3: South elevation of building, storefront entrance. Camera facing north.



Photograph 4: South elevation, window and parapet details. Camera facing north.

United States Department of the Interior  
National Park Service

# National Register of Historic Places Continuation Sheet

Section number PHOTOGRAPHS Page 3

<u>Spence Confectionery and Dance Hall</u> Name of Property
<u>Cache County, Utah</u> County and State
<u>N/A</u> Name of multiple listing (if applicable)



**Photograph 5:** North (rear) elevation. Camera facing south.



**Photograph 6:** North (rear) elevation, window detail. Camera facing south.

United States Department of the Interior  
National Park Service

# National Register of Historic Places Continuation Sheet

Section number PHOTOGRAPHS Page 4

Spence Confectionery and Dance Hall
Name of Property
Cache County, Utah
County and State
N/A
Name of multiple listing (if applicable)



**Photograph 7:** Interior, storefront entrance. Camera facing south.



**Photograph 8:** Interior, seating area. Camera facing south.

United States Department of the Interior  
National Park Service

# National Register of Historic Places Continuation Sheet

Section number PHOTOGRAPHS Page 5

Spence Confectionery and Dance Hall
Name of Property
Cache County, Utah
County and State
N/A
Name of multiple listing (if applicable)



Photograph 9: Interior, view to rear entry. Camera facing north.



Photograph 10: Interior, counter area. Camera facing northeast.

United States Department of the Interior  
National Park Service

National Register of Historic Places  
Continuation Sheet

Section number FIGURES Page 1

Spence Confectionery and Dance Hall

Name of Property

Cache County, Utah

County and State

N/A

Name of multiple listing (if applicable)



Figure 1

Confectionery building (photographed circa 1940).  
*Courtesy Tony Johnson Photograph Collection.*



The Confectionery - 1940's  
Vern Maughan

Figure 2

Confectionery building interior (photographed circa 1940s).  
*Courtesy Tony Johnson Photograph Collection.*

**United States Department of the Interior**  
National Park Service

**National Register of Historic Places**  
**Continuation Sheet**

Section number FIGURES Page 2

Spence Confectionery and Dance Hall

Name of Property

Cache County, Utah

County and State

N/A

Name of multiple listing (if applicable)



**Figure 3**

Wellsville commercial business district on Main Street (photographed circa 1966, confectionery in center).  
*Courtesy Tony Johnson Photograph Collection.*



**Figure 4**

81 E. and 85 E. Main Street behind false front Western façade (photographed in 2022).  
*Courtesy Tony Johnson Photograph Collection.*

**United States Department of the Interior**  
National Park Service

**National Register of Historic Places**  
**Continuation Sheet**

Section number FIGURES Page 3

Spence Confectionery and Dance Hall
Name of Property
Cache County, Utah
County and State
N/A
Name of multiple listing (if applicable)



**Figure 5**

85 E. Main Street, south elevation (photographed after false front removed in 2023).  
*Courtesy Author.*



**Figure 6**

85 E. Main Street, north elevation (photographed prior to shed removal).  
*Courtesy Author.*